



EVent™ SERIES

VENTING SYSTEMS
FOR HIGH EFFICIENCY
APPLIANCES



Underwriters
Laboratories Inc.®
LISTED

LISTINGS

The Schebler eVent™ and eVent™ PLUS system are tested and listed by Underwriters Laboratories Inc. (UL) under file number MH10056 for **UL 1738** and ULC S636-95 vent.

SYSTEM CONCEPT

eVent™ and eVent™ PLUS are modular double wall prefabricated vent and exhaust systems used in venting high efficiency appliances that require a positive, neutral or negative draft exhaust. Sections are provided in lightweight, easy-to-handle lengths. Connections are sealed with pressure tight drawbands and high temperature sealant. Straight sections, variable length joints, tees, elbows and support devices are offered, allowing a complete exhaust system to be assembled from standard components. eVent™ and eVent™ PLUS have a 1" air gap between the inner and outer shell. Schebler also offers 2" insulated product, eVent™ PLUS2, that utilizes AL 29-4C® liner and is UL 1738 listed. See eVent™ PLUS2 brochure for more information.

VENTING APPLICATIONS

eVent™ and eVent™ PLUS are double wall special stainless steel venting systems for gas fired appliances listed as Category II, III, and IV with a maximum flue gas temperature of 550°F, and 40" w.c. positive pressure. Gas vent - BH, Class I / Class II - 245°C. eVent™ is also suitable for other applications that call for an AL 29-4C® vent.

COMPLETE LINE OF FITTINGS AND SIZES AVAILABLE

The eVent™ series is available in even and odd diameters ranging from 5" to 48". A complete line of straight sections, variable lengths, tees, elbows, rain caps, roof penetration components and support members are offered. In addition to the standard components, virtually any conceivable fitting is available as a special order item.

MATERIAL AVAILABLE

eVent™ is available in a variety of materials allowing the proper material selection for your specific application. The standard product features a AL 29-4C® stainless steel liner and an aluminized steel outer shell.

Exterior installations which are not easily accessible for periodic painting, you should consider a 304 or 316 stainless steel outer shell which will require no maintenance.

MATERIAL THICKNESS

The standard material thickness for eVent™ liners is 24 ga. (.024"); for shells it is 22 ga. (.034"). eVent™ PLUS material thickness is 20 ga. (.036") for liners and 22 ga. (.034") for shells.

SUPPORT LIMITS

Support plates and wall supports are utilized to support the weight of the vent. In horizontal runs, supports should be placed adjacent to fittings that are not otherwise supported. See the individual part description for allowable support charts.

TESTS PERFORMED

eVent™ and eVent™ PLUS have endured rigorous tests by Underwriters Laboratories. Just a few of the tests performed are:

- **Structural Tests** The support plates and wall supports have been physically tested to carry a load 4 times that allowed by our listing.
- **Wind Load Tests** Loads equivalent to 110 mph wind have been applied to the chimney with acceptable results.
- **Pressure Tests** UL listed at 40" w.c. positive pressure.
- **Leak Tests** Joints have passed UL leakage test.
- **Rain Tests** The rain caps have been tested to ensure that an unsatisfactory amount of water does not enter the rain cap.

UNIQUE FEATURES

The eVent™ series offers unique features that no other vent manufacturer can provide.

- **Industries Highest Pressure Rating of 40" w.c.**
 - Reduces risk of leakage
- **Longest Straight Sections up to 71"**
 - Reduces installation time / cost
- **Greater Distance Between Supports**
 - Reduces installation cost
 - Solution to design challenges
- **Union Made Product**
- **Lifetime Warranty**

SCHEBLER VALUE

- **Fast Project Completion**
 - 2-week lead time (vs. industry standard 3-6 weeks)
 - Trouble-free installation / detailed instructions
 - No on-site welding
- **Maximum Strength / Long Life**
 - Unmatched dimensional accuracy for secure joint connections
 - Fully welded liners and shells
 - Unequalled support limits
- **Complete System Design**
 - CAD drawings
 - 3D design solutions
 - Complete BOM
 - System sizing
- **Special Fittings**

OPERATING TEMPERATURES AND CLEARANCES CHART

eVent™ and eVent™ PLUS have been tested and listed for a maximum flue gas temperature of 550°F, and ULC-S636-95 for gas vent-BH, Class I / Class II - 245°C. The clearances shown are from the shell to combustibles.

eVent™ Series Clearance to Combustibles

Section Inside Diameter	550°F (288°C)
5"-6"	1" (25mm)
7"-8"	1" (25mm)
9"-10"	1" (25mm)
11"-12"	1" (25mm)
13"-14"	1" (25mm)
15"-16"	1.5" (38mm)
17"-18"	1.5" (38mm)
19"-20"	1.5" (38mm)
21"-22"	2" (51mm)
23"-24"	2" (51mm)
25"-26"	3" (76mm)
27"-28"	3" (76mm)
29"-30"	3" (76mm)
31"-32"	3" (76mm)
33"-34"	4" (102mm)
35"-36"	4" (102mm)
37"-38"	4" (102mm)
39"-40"	4" (102mm)
41"-42"	4" (102mm)
43"-44"	5" (127mm)
45"-46"	5" (127mm)
47"-48"	5" (127mm)

Clearance to non-combustible materials for all diameters and applications is 0" (0mm).

PART NUMBERS

All standard parts manufactured by Schebler are identified by a part number which describes their make up and function.

The part numbers are made up as follows:

1. The first series is the model designation, EV (eVent™) and EVP (eVent™ PLUS).
2. This is followed by the part name.
For example 47S, 90T and CC.
3. Next is the part's internal diameter in inches, such as 06, 12, 24.
4. Last is the liner/shell material designation.

For example the part number for an 8" ID, eVent™, 47" long straight section with AL 29-4C® stainless steel liner and aluminized steel shell is: EV47S08K.

Code	Liner / Shell Material
F	Galvanized
G	Aluminized
H	Painted Carbon Steel
K	AL 29/Aluminized
L	AL 29/304
M	AL 29/316
R	AL 29/430

JOINT ASSEMBLY

Note: Wipe inner bands and flanges clean prior to assembly.

1. Apply continuous bead of proper sealant covering one of the flanges being joined.
2. Join the two flanged ends of the sections.
3. Fill the "V" in the inner band with the proper sealant.
4. Install the inner band around the flanges and tighten the screws.
5. Tap around the inner band with a rawhide mallet and retighten the screws to ensure a tight joint.
6. Place the outer band over the space between the shells of the adjoining sections and tighten the screws. For outdoor installations, apply a bead of S600 sealant in the groove at the upper end of the outer band.

SEALANT

Schebler S600 is used for all eVent™ applications.

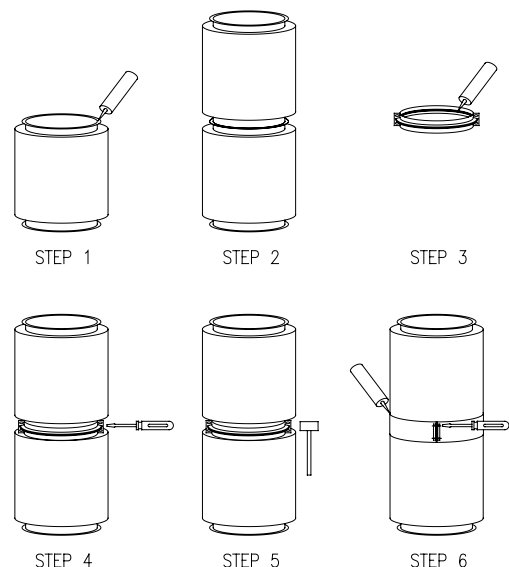
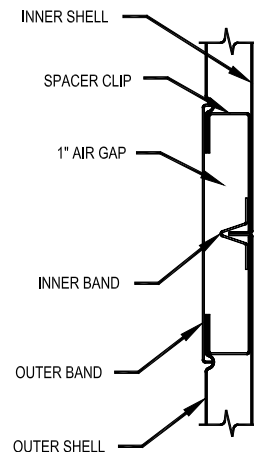

SYSTEM COMPONENTS

CUSTOM DIMENSIONS ARE AVAILABLE TO SUIT YOUR NEEDS IN EVEN AND ODD SIZES

ADAPTER KIT (FLANGED)

Part No. BKF

The Adapter Kit (Flanged) is used for securing pipe to a flanged appliance outlet. Beam clamps are provided for connection of the flanges, or the flange can be drilled in the field to match the appliance.

Includes 1 inner band and 1 seal ring to cover the gap between the inner and outer shells.

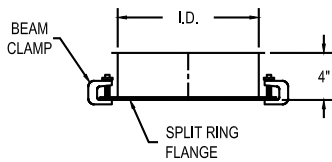

ADAPTER KIT (RAW)

Part No. BKR

The Adapter Kit (Raw) is used for securing pipe to an unflanged appliance outlet.

Includes 1 inner band and 1 seal ring to cover the gap between the inner and outer shells.

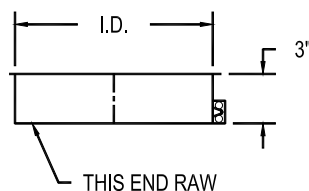

STRAIGHT SECTION

Part No. 17S, 35S, 47S and 71S

Standard lengths are as follows:

Diameter 5" - 12" is 17", 35", 47" and 71"

Diameter 13" - 14" is 17", 35" and 47"

Diameter 15" - 48" is 17" and 35"

Custom parts can be manufactured to any length over 8".

Includes 1 inner and 1 outer band.

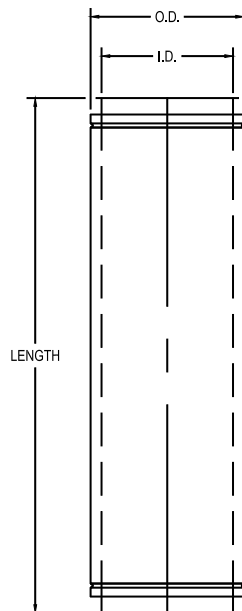

VARIABLE LENGTH SECTION

Part No. 17VS and VS

The Variable Section adjusts to provide a fixed odd length between two sections. The minimum length is 5", the maximum is 17" or 35". This part does not provide for thermal expansion.

Includes liner, shell, slip joint, and 1 inner band.

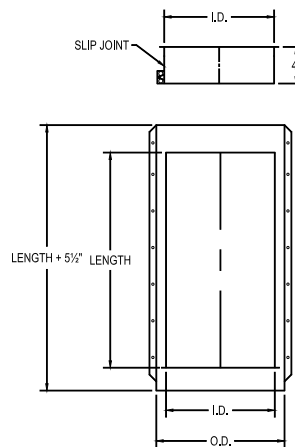

ABRUPT INCREASER

Part No. AI

The Abrupt Increaser is used to connect two sections of different diameters in a shorter space than a tapered increaser.

Includes 1 inner band of larger and smaller sizes and 1 seal ring.

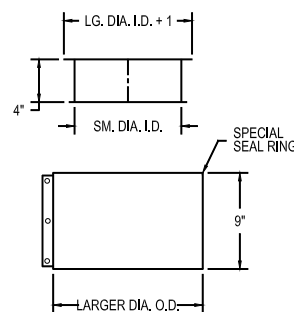

45° LATERAL TEE

Part No. 45LT

The 45° Lateral Tee is used for low flow resistance entry into a stack or breeching.

Includes 2 inner bands and 2 outer bands.

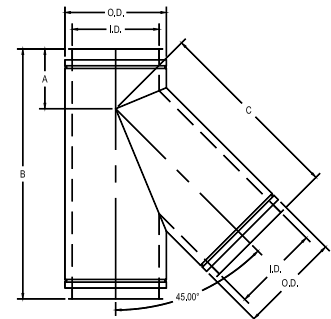

Part No. 45LT

I.D.	A	B	C
5-6"	4 7/8"	18 3/8"	13 1/2"
7-8"	5 1/4"	21"	15 3/4"
9-10"	5 11/16"	23 7/8"	18 3/16"
11-12"	6 1/16"	26 11/16"	20 9/16"
13-14"	6 1/2"	29 1/2"	23"
15-16"	6 15/16"	32 5/16"	25 7/8"
17-18"	7 5/16"	35 3/16"	27 13/16"
19-20"	7 3/4"	38"	30 1/4"
21-22"	8 3/16"	40 13/16"	32 11/16"
23-24"	8 9/16"	43 5/8"	35 11/16"
25-26"	9"	46 1/2"	37 1/2"
27-28"	9 3/8"	49 5/16"	39 7/8"
29-30"	9 13/16"	52 1/8"	42 5/16"
31-32"	10 1/4"	54 15/16"	44 3/4"
33-34"	10 5/8"	57 13/16"	47 1/8"
35-36"	11 1/16"	60 5/8"	49 9/16"
37-38"	11 1/2"	63 7/16"	52"
39-40"	11 7/8"	66 1/4"	54 3/8"
41-42"	12 5/16"	69 1/8"	56 13/16"
43-44"	12 11/16"	71 15/16"	59 3/16"
45-46"	12 3/4"	74 3/4"	61 5/8"
47-48"	13 9/16"	77 9/16"	64 1/16"

REDUCING 45° LATERAL TEE

Part No. R45LT

The Reducing 45° Lateral Tee is used for low flow resistance entry into a stack or breeching when the stack or breeching is a larger size. Specify size of branch required.

Includes 1 each inner band and outer band for larger and smaller opening.

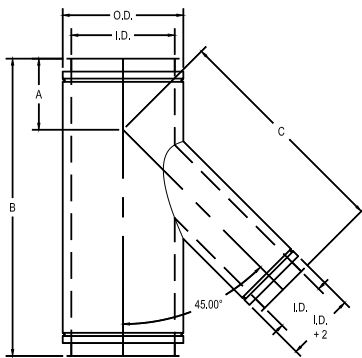

Part No. R45LT			
I.D.	A	B	C
5-6"	4 1/16"	16 3/4"	12 15/16"
7-8"	3 7/8"	18 3/16"	14 3/4"
9-10"	4 1/4"	21"	17 3/16"
11-12"	4 11/16"	23 7/8"	19 9/16"
13-14"	5 1/16"	26 11/16"	22"
15-16"	5 1/2"	29 1/2"	24 7/16"
17-18"	5 15/16"	32 5/16"	26 13/16"
19-20"	6 5/16"	35 3/16"	29 1/4"
21-22"	6 3/4"	38"	31 11/16"
23-24"	7 3/16"	40 13/16"	34 1/16"
25-26"	7 9/16"	43 5/8"	36 1/2"
27-28"	8"	46 1/2"	38 7/8"
29-30"	8 3/8"	49 5/16"	41 5/16"
31-32"	8 13/16"	52 1/8"	43 3/4"
33-34"	9 1/4"	54 15/16"	46 1/8"
35-36"	9 5/8"	57 13/16"	48 9/16"
37-38"	10 1/16"	60 5/8"	51"
39-40"	10 1/2"	63 7/16"	53 3/8"
41-42"	10 7/8"	66 1/4"	55 13/16"
43-44"	11 5/16"	69 1/8"	58 3/16"
45-46"	11 11/16"	71 15/16"	60 5/8"
47-48"	12 1/8"	74 3/4"	63 1/16"

TAPERED INCREASER

Part No. TI

The Tapered Increaser is used when a change in pipe diameter is required.

Includes 1 inner and 1 outer band of both smaller and larger size.

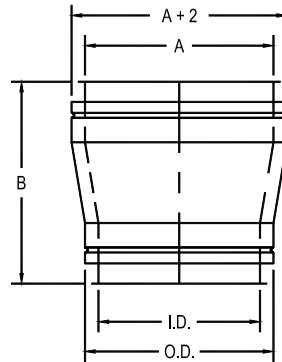

Part No. TI								
I.D.	A	B	A	B	A	B	A	B
6"	8"	15"	10"	18"	12"	21"	14"	24"
8"	10"	15"	12"	18"	14"	21"	16"	24"
10"	12"	15"	14"	18"	16"	21"	18"	24"
12"	14"	15"	16"	18"	18"	21"	20"	24"
14"	16"	15"	18"	18"	20"	21"	22"	24"
16"	18"	15"	20"	18"	22"	21"	24"	24"
18"	20"	15"	22"	18"	24"	21"	26"	24"
20"	22"	15"	24"	18"	26"	21"	28"	24"
22"	24"	15"	26"	18"	28"	21"	30"	24"
24"	26"	15"	28"	18"	30"	21"	32"	24"
26"	28"	15"	30"	18"	32"	21"	34"	24"
28"	30"	15"	32"	18"	34"	21"	36"	24"
30"	32"	15"	34"	18"	36"	21"	38"	24"
32"	34"	15"	36"	18"	38"	21"	40"	24"
34"	36"	15"	38"	18"	40"	21"	42"	24"
36"	38"	15"	40"	18"	42"	21"	44"	24"
38"	40"	15"	42"	18"	44"	21"	46"	24"
40"	42"	15"	44"	18"	46"	21"	48"	24"
42"	44"	15"	46"	18"	48"	21"	~	~
44"	46"	15"	48"	18"	~	~	~	~
46"	48"	15"	~	~	~	~	~	~
48"	~	~	~	~	~	~	~	~

Available in odd sizes.

Call for odd diameter taper increaser information.

SYSTEM COMPONENTS

CUSTOM DIMENSIONS ARE AVAILABLE TO SUIT YOUR NEEDS IN EVEN AND ODD SIZES

90° TEE

Part No. 90T

The 90° Tee is used to join horizontal and vertical sections, as well as to provide for connection of drain or inspection fittings. Use either the drain tee cap or the end cap for closure of the unused opening.

Includes 2 inner bands and 2 outer bands.

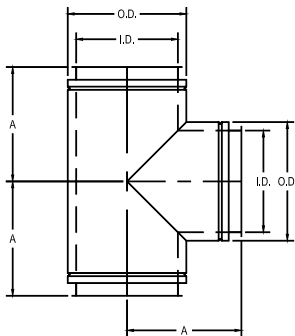

Part No. 90T	
I.D.	A
5"	6 1/2"
6"	7 1/8"
7-8"	8"
9-10"	9"
11-12"	10"
13-14"	11"
15-16"	12"
17-18"	13"
19-20"	14"
21-22"	15"
23-24"	16"
25-26"	17"
27-28"	18"
29-30"	19"
31-32"	20"
33-34"	21"
35-36"	22"
37-38"	23"
39-40"	24"
41-42"	25"
43-44"	26"
45-46"	27"
47-48"	28"

REDUCING 90° TEE

Part No. R90T

The Reducing 90° Tee is used to join horizontal and vertical sections of different sizes, as well as provide for connection to drain or inspection fittings. Use either the drain tee cap or the end cap for closure of the unused opening. Specify size of branch required.

Includes 1 each inner band and outer band for larger and smaller opening.

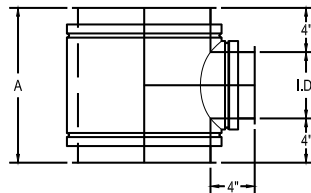

Part No. R90T	
I.D.	A
5-6"	14 1/8"
7-8"	16"
9-10"	18"
11-12"	20"
13-14"	22"
15-16"	24"
17-18"	26"
19-20"	28"
21-22"	30"
23-24"	32"
25-26"	34"
27-28"	36"
29-30"	38"
31-32"	40"
33-34"	42"
35-36"	44"
37-38"	46"
39-40"	48"
41-42"	50"
43-44"	52"
45-46"	54"

90° BOOT TEE

Part No. BT

The 90° Boot Tee is used to join horizontal and vertical sections with lower resistance as well as to provide for connection of drain or inspection fittings. Use either the drain tee cap or the end cap for closure of the unused opening.

Includes 2 inner bands and 2 outer bands.

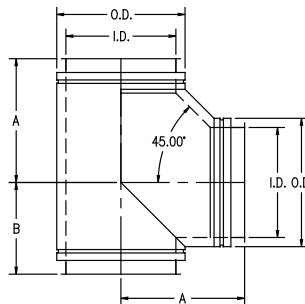

Part No. BT		
I.D.	A	B
5"	10 1/2"	6 1/2"
6"	10 1/2"	7 1/8"
7-8"	11 1/2"	8"
9-10"	12 1/2"	9"
11-12"	13 1/2"	10"
13-14"	14 1/2"	11"
15-16"	15 1/2"	12"
17-18"	16 1/2"	13"
19-20"	17 1/2"	14"
21-22"	18 1/2"	15"
23-24"	19 1/2"	16"
25-26"	20 1/2"	17"
27-28"	21 1/2"	18"
29-30"	22 1/2"	19"
31-32"	23 1/2"	20"
33-34"	24 1/2"	21"
35-36"	25 1/2"	22"
37-38"	26 1/2"	23"
39-40"	27 1/2"	24"
41-42"	28 1/2"	25"
43-44"	29 1/2"	26"
45-46"	30 1/2"	27"
47-48"	31 1/2"	28"

90° WYE

Part No. 90Y

The 90° Wye is used for joining runs where low flow resistance is desired. All openings must be the same size. For connection to smaller diameter sections use the tapered or abrupt increasers.

Includes 2 inner bands and 2 outer bands.

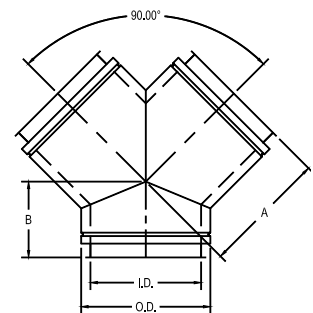

Part No. 90Y		
I.D.	A	B
5-6"	10 1/2"	7"
7-8"	11 1/2"	7 13/32"
9-10"	12 1/2"	7 13/16"
11-12"	13 1/2"	8 7/32"
13-14"	14 1/2"	8 5/8"
15-16"	15 1/2"	9 1/16"
17-18"	16 1/2"	9 7/16"
19-20"	17 1/2"	9 7/8"
21-22"	18 1/2"	10 9/32"
23-24"	19 1/2"	10 23/32"
25-26"	20 1/2"	11 1/8"
27-28"	21 1/2"	11 17/32"
29-30"	22 1/2"	11 31/32"
31-32"	23 1/2"	12 3/8"
33-34"	24 1/2"	12 25/32"
35-36"	25 1/2"	13 3/16"
37-38"	26 1/2"	13 11/16"
39-40"	27 1/2"	14 1/32"
41-42"	28 1/2"	14 15/32"
43-44"	29 1/2"	14 27/32"
45-46"	30 1/2"	15 1/4"
47-48"	31 1/2"	15 11/16"

90° ELBOW

Part No. 90L

The 90° Elbow is used when making a 90° directional change. The 90° elbow is available in sizes 5" through 24". For a 90° directional change in diameters from 25" through 48" use two 45° elbows.

Includes 1 inner and 1 outer band.

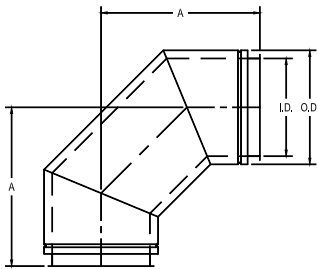

Part No. 90L	
I.D.	A
5-6"	9 11/16"
7-8"	10 7/8"
9-10"	11 7/16"
11-12"	12 11/16"
13-14"	13 7/8"
15-16"	15 1/16"
17-18"	15 11/16"
19-20"	16 7/8"
21-22"	17 1/2"
23-24"	18 11/16"

45° ELBOW

Part No. 45L

The 45° Elbow is used when a vertical or horizontal direction change of 45° is desired.

Includes 1 inner and 1 outer band.

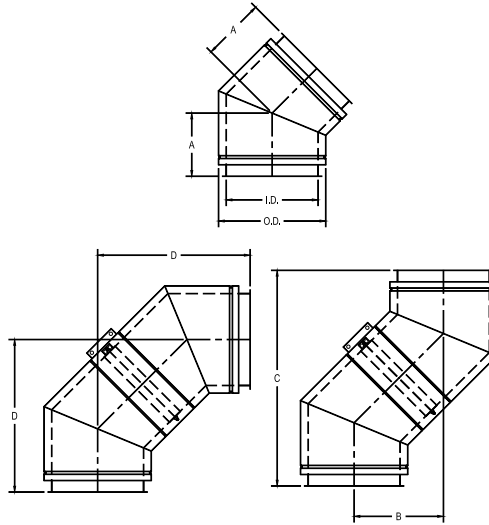

Part No. 45L				
I.D.	A	B	C	D
5-6"	7"	9 29/32"	23 29/32"	16 29/32"
7-8"	7 3/8"	10 7/16"	25 3/16"	17 13/16"
9-10"	7 3/16"	11 3/64"	26 43/64"	18 55/64"
11-12"	8 1/4"	11 43/64"	28 11/64"	19 59/64"
13-14"	8 5/8"	12 13/64"	29 29/64"	20 53/64"
15-16"	9 1/16"	12 13/16"	30 15/16"	21 7/8"
17-18"	9 1/2"	13 7/16"	32 7/16"	22 15/16"
19-20"	9 7/8"	13 31/32"	33 23/32"	23 27/32"
21-22"	10 5/16"	14 37/64"	35 13/64"	24 57/64"
23-24"	10 3/4"	15 13/64"	36 45/64"	25 61/64"
25-26"	11 1/8"	15 47/64"	37 63/64"	26 55/64"
27-28"	11 9/16"	16 23/64"	39 31/64"	27 59/64"
29-30"	11 15/16"	16 7/8"	40 3/4"	28 13/16"
31-32"	12 3/8"	17 1/2"	42 1/4"	29 7/8"
33-34"	12 3/4"	18 1/32"	43 17/32"	30 25/32"
35-36"	13 3/16"	18 21/32"	45 1/32"	31 27/32"
37-38"	13 5/8"	19 17/64"	46 33/64"	32 57/64"
39-40"	14"	19 51/64"	47 51/64"	33 51/64"
41-42"	14 7/16"	20 27/64"	49 19/64"	34 55/64"
43-44"	14 7/8"	21 1/32"	50 25/32"	35 29/64"
45-46"	15 1/4"	21 9/16"	52 1/16"	36 13/16"
47-48"	15 11/16"	22 3/16"	53 9/16"	37 7/8"

30° ELBOW

Part No. 30L

The 30° Elbow is used when a vertical or horizontal direction change of 30° is desired.

Includes 1 inner and 1 outer band.

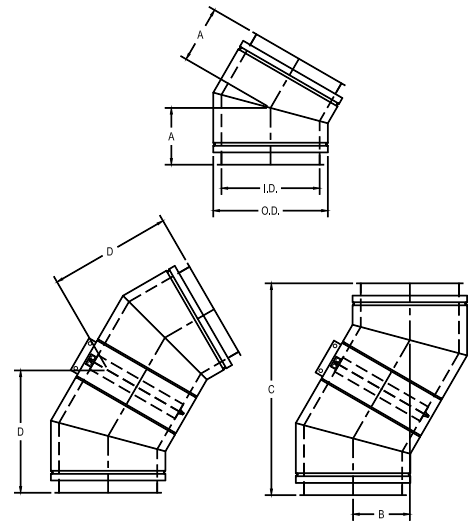

Part No. 30L				
I.D.	A	B	C	D
5-6"	6 1/8"	6 1/8"	22 55/64"	13 13/64"
7-8"	6 3/8"	6 3/8"	23 51/64"	13 47/64"
9-10"	6 5/8"	6 5/8"	24 23/32"	14 9/32"
11-12"	6 15/16"	6 15/16"	25 57/64"	14 61/64"
13-14"	7 3/16"	7 3/16"	26 53/64"	15 31/64"
15-16"	7 7/16"	7 7/16"	27 3/4"	16 1/32"
17-18"	7 3/4"	7 3/4"	28 59/64"	16 45/64"
19-20"	8"	8"	29 55/64"	17 15/64"
21-22"	8 1/4"	8 1/4"	30 51/64"	17 23/32"
23-24"	8 1/2"	8 1/2"	31 23/32"	18 5/16"
25-26"	8 3/4"	8 3/4"	32 21/32"	18 55/64"
27-28"	9 1/16"	9 1/16"	33 53/64"	19 17/32"
29-30"	9 5/16"	9 5/16"	34 3/4"	20 1/16"
31-32"	9 9/16"	9 9/16"	35 11/16"	20 39/64"
33-34"	9 7/8"	9 7/8"	36 55/64"	21 9/32"
35-36"	10 1/8"	10 1/8"	37 25/32"	21 13/16"
37-38"	10 3/8"	10 3/8"	38 23/32"	22 23/64"
39-40"	10 5/8"	10 5/8"	39 21/32"	22 57/64"
41-42"	10 15/16"	10 15/16"	40 13/16"	23 9/16"
43-44"	11 3/16"	11 3/16"	41 3/4"	24 7/64"
45-46"	11 1/2"	11 1/2"	42 59/64"	24 25/32"
47-48"	11 3/4"	11 3/4"	43 55/64"	25 5/16"

SYSTEM COMPONENTS

CUSTOM DIMENSIONS ARE AVAILABLE TO SUIT YOUR NEEDS IN EVEN AND ODD SIZES

END CAP

Part No. EC

The End Cap is used to close an unused tee opening and to provide a means of accessing the interior of the system for inspection and cleaning.

Includes 1 inner band.

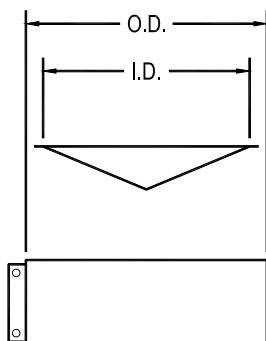

DRAIN TEE CAP

Part No. DTC

The Drain Tee Cap is used to close an unused tee opening and to provide a drain at the base of a vertical vent.

Includes 1 inner band.

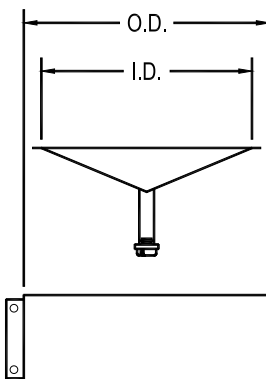

DRAIN SECTION

Part No. DS

The Drain Section is used to drain rain water and condensation from within the stack. The NPT nipple should be connected to a suitable drain.

Includes 1 inner and 1 outer band.

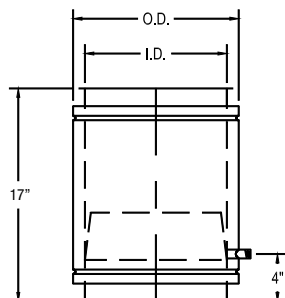

HORIZONTAL DRAIN

Part No. HD

The Horizontal Drain is used to drain rain water and condensation from within the stack. The NPT nipple should be connected to a suitable drain.

Includes 1 inner and 1 outer band.

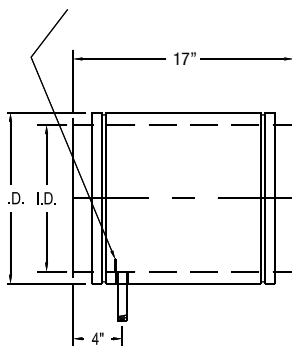

BASE DRAIN SECTION

Part No. BD

The Base Drain Section provides a bottom closure and drain attachment for base supported vents.

Includes 1 inner and 1 outer band.

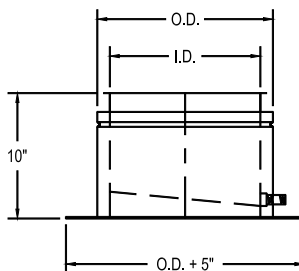

FLASHING

Part No. FL

The Flashing is used in conjunction with the rain collar to seal roof penetrations. This part is designed for flat roofs. Custom pitched flashings are available upon request.

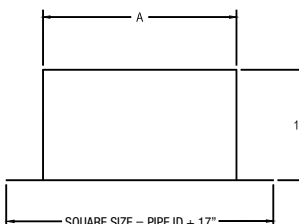

RAIN COLLAR

Part No. RC

The Rain Collar is used in conjunction with the flashing to seal roof penetrations.

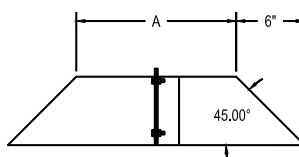

EXIT CONE

Part No. EXC

The Exit Cone is used to increase the flue gas velocity exiting the stack. A drain should be used at the base of stacks to remove any water that enters the stack.

Includes 1 inner band and 1 closure ring to seal outer shell joint.

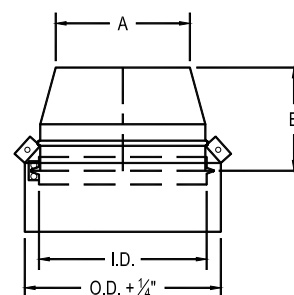

Part No. EXC		
I.D.	A	B
6"	4 7/8"	5 3/8"
8"	6 1/2"	6 1/8"
10"	8 1/8"	6 3/4"
12"	9 3/4"	7 1/2"
14"	11 3/8"	8 1/8"
16"	13 1/8"	8 7/8"
18"	14 3/4"	9 1/2"
20"	16 3/8"	10 1/4"
22"	18"	10 7/8"
24"	19 5/8"	11 5/8"
26"	21 1/4"	12 1/4"
28"	22 7/8"	13"
30"	24 1/2"	13 5/8"
32"	26 1/8"	14 3/8"
34"	27 3/4"	15"
36"	29 3/8"	15 3/4"
38"	31"	16 3/8"
40"	32 5/8"	17 1/8"
42"	34 1/4"	17 3/4"
44"	35 7/8"	18 1/2"
46"	37 1/2"	19 1/8"
48"	39 1/4"	19 3/4"

INSULATED THIMBLE

Part No. IT

The Insulated Thimble is used when penetrating a combustible wall or roof. This part is designed for flat roofs. Custom pitched thimbles are available upon request.

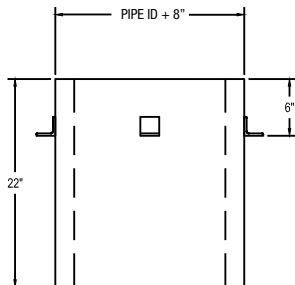

RAIN CAP

Part No. CC

The Rain Cap is used at stack terminations to prevent water from entering the flue. A drain should be used at the base of stacks to drain off water that may be blown into the flue.

Includes 1 inner band and 1 closure ring to seal outer shell joint.

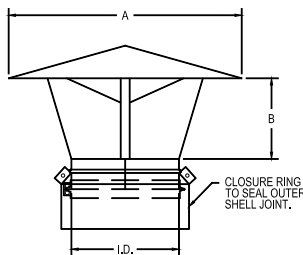

TOP SECTION

Part No. TS

The Top Section is used to protect the insulating space between the inner and outer shells when an open termination is required. A drain should be used at the base of stacks to drain off water that enters the system.

Includes 1 inner band and shell joint.

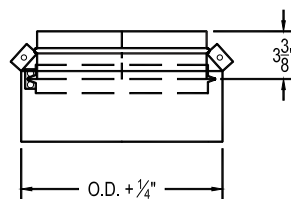

FAN ADAPTER

Part No. FA

The Fan Adapter is used to attach to an exhaust fan.

Includes 1 inner and 1 outer band.

Note: Plenum boxes available for multiple fan systems.

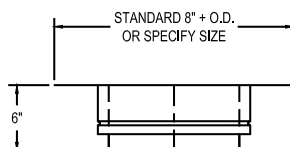

HORIZONTAL TERMINATION

Part No. HT

The Horizontal Termination is used when the stack terminates in a horizontal position. Birdscreen covers the opening to prevent any birds or rodents from entering.

Includes 1 inner and 1 outer band.

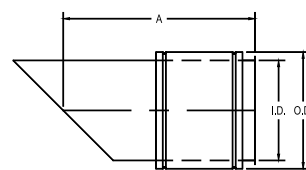

GUY SECTION

Part No. GS

The Guy Section is to be used when the chimney extends beyond the vertical limits above the roof line. The guy section should be connected to guy wires or a rigid guying structure.

Includes 1 inner band and 2 half outer bands.

Note: This part must be placed at the connection of two flue sections.

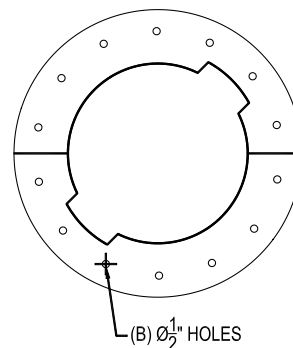

FULL RING

Part No. FR

The Full Ring is used to guide horizontal and vertical runs. The part is simply bolted around the outer shell then rigidly connected to the building structure.

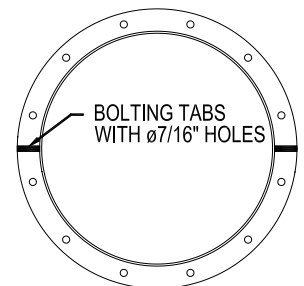

HALF RING

Part No. HR

The Half Ring is used to support long horizontal runs, placed under the flue and then supported by rods connecting to the building structure.

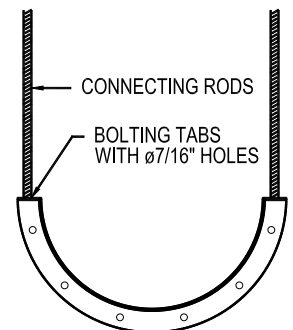

SYSTEM COMPONENTS

CUSTOM DIMENSIONS ARE AVAILABLE TO SUIT YOUR NEEDS IN EVEN AND ODD SIZES

SUPPORT PLATE

Part No. SP

The Support Plate is the primary load carrying member of the vent assembly. This part is designed to support (B) (See Chart Below) feet of vertical vent section as well as provide fixed points in breaching runs.

Includes 1 inner band and 2 half outer bands.

Note: This part must be placed at the connection of two flue sections.

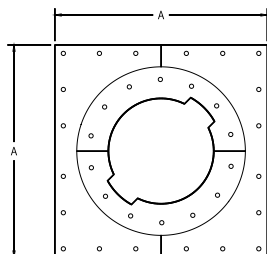

Part No. SP		
I.D.	A	B(FT)
5-6"	19 ³ / ₁₆ "	306'
7-8"	21 ³ / ₁₆ "	269'
9-10"	23 ³ / ₁₆ "	255'
11-12"	25 ³ / ₁₆ "	237'
13-14"	27 ³ / ₁₆ "	227'
15-16"	29 ³ / ₁₆ "	213'
17-18"	31 ³ / ₁₆ "	201'
19-20"	34 ³ / ₁₆ "	192'
21-22"	36 ³ / ₁₆ "	180'
23-24"	38 ³ / ₁₆ "	172'
25-26"	40 ³ / ₁₆ "	161'
27-28"	42 ³ / ₁₆ "	151'
29-30"	44 ³ / ₁₆ "	142'
31-32"	46 ³ / ₁₆ "	161'
33-34"	48 ³ / ₁₆ "	151'
35-36"	50 ³ / ₁₆ "	113'
37-38"	52 ³ / ₁₆ "	101'
39-40"	54 ³ / ₁₆ "	93'
41-42"	56 ³ / ₁₆ "	85'
43-44"	58 ³ / ₁₆ "	76'
45-46"	60 ³ / ₁₆ "	68'
47-48"	62 ³ / ₁₆ "	60'

WALL SUPPORT

Part No. WS

The Wall Support is used to provide vent support along a wall. The wall support will maintain the required clearance to combustible structures when properly installed and can support (C) (See Chart Below) feet of vertical chimney.

Includes 1 inner band and 2 half outer bands.

Note: This part must be placed at the connection of two flue sections.

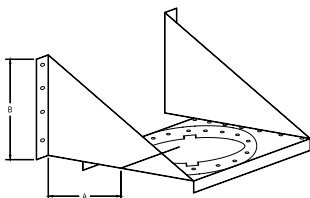

Part No. WS			
I.D.	A	B	C(FT)
5-6"	11"	12 ³ / ₈ "	193'
7-8"	13"	14 ³ / ₈ "	171'
9-10"	14"	15 ³ / ₄ "	164'
11-12"	15"	17 ¹ / ₁₆ "	153'
13-14"	17"	19 ¹ / ₁₆ "	148'
15-16"	18"	20 ⁷ / ₁₆ "	140'
17-18"	20"	22 ¹ / ₂ "	134'
19-20"	21"	24 ¹ / ₈ "	129'
21-22"	23"	26 ³ / ₁₆ "	123'
23-24"	24"	27 ¹ / ₂ "	119'
25-26"	26"	29 ¹ / ₂ "	113'
27-28"	27"	30 ⁷ / ₈ "	108'
29-30"	29"	32 ⁷ / ₈ "	103'
31-32"	30"	34 ¹ / ₄ "	120'
33-34"	32"	36 ¹ / ₄ "	114'
35-36"	33"	37 ⁵ / ₈ "	88'
37-38"	35"	39 ⁹ / ₁₆ "	81'
39-40"	36"	40 ¹⁵ / ₁₆ "	77'
41-42"	38"	42 ¹⁵ / ₁₆ "	73'
43-44"	39"	44 ⁵ / ₁₆ "	68'
45-46"	44"	47"	64'
47-48"	45"	49 ¹¹ / ₁₆ "	60'

FLOOR/ROOF GUIDE

Part No. FRG

The Floor/Roof Guide is used at the penetration of floors and roofs to guide the vent. This part is designed to absorb lateral loads only. It will not support vertical vent sections.

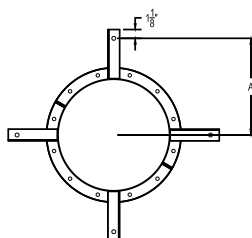

Part No. FRG	
I.D.	A
5"	8 ⁷ / ₈ "
6"	9 ³ / ₈ "
7-8"	10 ³ / ₈ "
9-10"	11 ³ / ₈ "
11-12"	12 ³ / ₈ "
13-14"	13 ³ / ₈ "
15-16"	14 ³ / ₈ "
17-18"	15 ³ / ₈ "
19-20"	16 ³ / ₈ "
21-22"	17 ³ / ₈ "
23-24"	18 ³ / ₈ "
25-26"	19 ³ / ₈ "
27-28"	20 ³ / ₈ "
29-30"	21 ³ / ₈ "
31-32"	22 ³ / ₈ "
33-34"	23 ³ / ₈ "
35-36"	24 ³ / ₈ "
37-38"	25 ³ / ₈ "
39-40"	26 ³ / ₈ "
41-42"	27 ³ / ₈ "
43-44"	28 ³ / ₈ "
45-46"	29 ³ / ₈ "
47-48"	30 ³ / ₈ "

WALL GUIDE

Part No. WG

The Wall Guide is used to guide long vertical runs that are placed adjacent to walls. This part will maintain proper clearance to combustibles when properly installed.

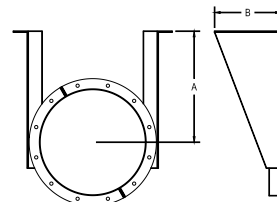

Part No. WG		
I.D.	A	B
5-6"	11"	7 ¹³ / ₁₆ "
7-8"	13"	8 ¹ / ₂ "
9-10"	14"	8 ⁵ / ₈ "
11-12"	15"	9"
13-14"	17"	9 ⁷ / ₁₆ "
15-16"	18"	9 ³ / ₄ "
17-18"	20"	10 ¹ / ₄ "
19-20"	21"	10 ⁹ / ₁₆ "
21-22"	23"	11 ¹ / ₈ "
23-24"	24"	11 ⁵ / ₁₆ "
25-26"	26"	11 ⁷ / ₈ "
27-28"	27"	12 ¹ / ₈ "
29-30"	29"	12 ¹¹ / ₁₆ "
31-32"	30"	12 ¹⁵ / ₁₆ "
33-34"	32"	13 ¹ / ₂ "
35-36"	33"	13 ¹¹ / ₁₆ "
37-38"	35"	14 ⁵ / ₁₆ "
39-40"	36"	14 ¹ / ₂ "
41-42"	38"	15 ¹ / ₁₆ "
43-44"	39"	15 ⁵ / ₁₆ "
45-46"	44"	16 ¹¹ / ₁₆ "
47-48"	45"	16 ⁷ / ₈ "

eVent™ WEIGHT CHART

		Inside Diameter (Inches)																							
Part Description	Part No.	5"	6"	8"	10"	12"	14"	16"	18"	20"	22"	24"	26"	28"	30"	32"	34"	36"	38"	40"	42"	44"	46"	48"	
17" Straight Section	17S	15 lbs.	18	21	25	29	32	36	39	43	47	50	54	58	61	77	81	85	103	108	113	118	123	128	
35" Straight Section	35S	20 lbs.	26	25	29	33	38	42	46	50	55	59	63	67	72	90	95	100	121	126	132	138	144	150	
30 Degree Elbow	30L	5 lbs.	8	10	12	15	18	20	23	26	30	33	36	40	44	47	51	67	85	91	98	105	112	119	
45 Degree Elbow	45L	5 lbs.	9	11	14	17	20	24	27	31	35	40	44	49	54	59	64	85	108	116	125	135	144	154	
45 Degree Tee	45LT	17 lbs.	18	26	34	43	53	64	76	88	102	117	133	150	168	186	205	283	356	388	422	457	493	531	
47" Straight Section	47S	27 lbs.	23	30	36	-	-	-	-	-	-	-	-	-	-	-	-	-	-	-	-	-	-	-	
71" Straight Section	71S	40 lbs.	-	60	72	-	-	-	-	-	-	-	-	-	-	-	-	-	-	-	-	-	-	-	
90 Degree Elbow	90L	7 lbs.	12	17	23	30	38	46	55	65	76	88	-	-	-	-	-	-	-	-	-	-	-	-	
90 Degree Tee	90T	10 lbs.	15	19	25	31	37	44	52	60	68	77	87	97	107	118	130	176	221	240	259	280	301	322	
Abrupt Increaser	AI	5 lbs.	7	8	10	11	13	15	16	18	20	21	23	24	26	28	29	31	39	41	43	45	47	49	
Base Drain	BD	12 lbs.	12	15	17	20	23	26	28	31	34	37	39	42	45	48	51	59	72	76	79	83	87	90	
Boiler Kit Flanged	BKF	5 lbs.	7	8	10	11	13	15	16	18	20	21	23	24	26	28	29	31	39	41	43	45	47	49	
Boiler Kit Raw	BKR	5 lbs.	4	5	6	7	8	8	9	10	11	12	13	14	15	15	16	17	25	26	27	29	30	31	
Drain Section	DS	8 lbs.	11	14	17	20	23	26	29	32	35	37	40	43	46	49	52	66	83	87	91	95	99	103	
Drain Tee Cap	DTC	4 lbs.	5	6	7	8	9	11	12	14	16	18	20	22	25	27	30	39	51	55	59	64	69	74	
End Cap	EC	3 lbs.	4	5	6	7	8	10	11	13	15	17	19	21	24	26	29	38	50	54	58	63	68	73	
Fan Adapter	FA	10 lbs.	7	8	10	11	13	15	16	18	20	21	23	24	26	28	29	31	39	41	43	45	47	49	
Flashing	FL	11 lbs.	11	12	13	15	16	18	19	21	22	24	25	27	29	30	32	34	35	37	39	40	42	44	
Floor/Roof Guide	FRG	11 lbs.	10	10	11	12	15	16	17	18	19	24	25	27	27	30	30	32	33	34	35	36	38	39	
Full Ring	FR	3 lbs.	3	4	5	6	9	10	11	12	13	18	19	21	21	24	24	26	27	28	29	30	32	33	
Guy Section	GS	8 lbs.	9	11	13	14	16	18	20	22	23	25	27	29	31	32	34	36	42	44	46	48	50	52	
Half Ring	HR	2 lbs.	2	2	3	3	5	5	6	6	7	9	10	11	11	12	12	13	14	14	15	15	16	17	
Horizontal Drain	HD	8 lbs.	11	14	17	20	23	26	29	32	35	37	40	43	46	49	52	66	83	87	91	95	99	103	
Insulated Thimble	IT	19 lbs.	20	22	25	28	31	33	36	39	42	44	47	50	52	55	58	61	63	66	69	72	74	77	
Nozzle Section	NS	9 lbs.	11	14	17	20	23	26	29	32	35	37	40	43	46	49	52	66	83	87	91	95	99	103	
Rain Cap	CC	8 lbs.	9	11	13	16	18	21	24	27	31	34	37	41	45	52	57	65	73	79	86	92	99	105	
Rain Collar	RC	4 lbs.	4	5	5	6	6	7	7	8	8	9	9	10	10	11	11	12	12	13	13	14	14	15	
Support Plate	SP	31 lbs.	31	36	42	47	53	58	64	70	76	99	107	114	122	130	138	146	186	196	206	217	227	238	
Tapered Increaser	TI	9 lbs.	13	16	20	23	27	30	33	37	40	44	47	50	54	57	61	78	97	102	106	111	116	121	
Top Section	TS	3 lbs.	3	4	5	5	6	7	8	9	9	10	11	12	12	13	14	17	21	22	23	24	25	26	
Variable Section	VS	14 lbs.	23	30	36	43	49	56	62	68	75	81	88	94	101	107	113	148	181	190	199	209	218	227	
Wall Guide	WG	13 lbs.	14	17	19	21	26	28	31	34	37	44	48	50	53	57	60	62	66	69	73	75	85	87	
Wall Support	WS	47 lbs.	51	61	73	84	97	108	124	138	156	186	206	222	244	262	285	304	360	381	416	439	477	501	

All weights shown above are actual weights, for shipping weights multiply by 1.25

SAMPLE SPECIFICATION - eVent™

The factory built modular vent shall be laboratory tested and listed in accordance with Underwriters Laboratories Standard UL 1738 for use with category II, III, & IV appliances with a maximum flue gas temperature of 550°F and ULC-S636-95 for gas vent - BH, Class I / Class II 245°C.

Vent sections shall be sealed with ½" banded flanges and silicone joint sealant for temperatures up to 600°F with a UL tested pressure rating of 40" w.c.

Inner shell material shall be type AL 29-4C® stainless steel. Inner shell thickness shall be .024" (24 ga. eVent™) and .036" (20 ga. eVent™ PLUS) for 5" to 48" diameter systems. All inner shell seams shall be full penetration welded. Riveted, tack or spot welded seams are not permitted.

Outer shell material shall be aluminized steel with a thickness of .034" for 5" to 48" diameter systems. Optional outer shell material can be 304 or 316 stainless steel.

All outer shell seams shall be full penetration welded the entire length of the pipe section. Riveted, tack or spot welded seams are not permitted.

Between the inner and outer shells there shall be a minimum 1" air gap. Stainless steel centering clips shall be welded to the outer shell to maintain the 1" spacing and ensure concentricity of the shells.

Breeching and vent sections, when installed according to manufacturer's instructions, shall comply with national safety standards and building codes. Stacks terminating above a roof must terminate as required by code or NFPA 211.

Vent sections exposed to atmospheric conditions shall be protected by a minimum of one base coat and one finish coat of heat resistant paint after installation. Outer shells of type 304 or 316 stainless steel need not be painted.

eVent™ LIFETIME WARRANTY

The Schebler Company warrants eVent™ model products installed in UL 1738 condensing applications against defects in material and workmanship for the entire duration the product is incorporated and used in its original installation when said product is properly installed per Schebler's design and current installation instructions or specifications, and is properly connected to a code compliant venting system for category IV appliances. This warranty is subject to all terms and conditions described in The Schebler Company's Standard Terms and Conditions of Sale.

The Schebler Company will, at its sole discretion, either repair or replace any defective product covered by this Limited Warranty at no charge, provided however Buyer shall be responsible for all costs of removal, shipping, and reinstallation of the product. Furthermore, this warranty does not apply to any system component not manufactured by Schebler Company and installed as part of the UL system. Repair or replacement of products provided under this Limited Warranty are similarly warranted for the remainder of the original warranty term.

This limited warranty is extended solely to the original owner subject to the satisfaction of the following conditions:

- 1) System sizing and design has been performed by Schebler personnel and the design parameters provided to The Schebler Company by the responsible engineer were and are accurately representative of the system operating conditions.
- 2) The undamaged components have been correctly installed in accordance with Schebler system design and sizing, and installation instructions published by The Schebler Company.
- 3) All horizontal breeching in the system is properly pitched back toward the appliances to allow condensate to flow to, and be removed by, horizontal drains, drain sections, drain tee caps and/or base drain sections.

- 4) The Schebler Company has supplied the entire vent system from connection to the appliance to the termination of the vent.
- 5) Any portion of the system exposed to the atmosphere has an outer shell constructed of stainless steel.

The Schebler Company makes no other warranty, whether expressed or implied. This warranty shall be the sole and exclusive remedy of any Buyer, whether in contract, tort or otherwise. UNDER NO CIRCUMSTANCES SHALL THE SCHEBLER COMPANY BE LIABLE FOR ANY INCIDENTAL OR CONSEQUENTIAL DAMAGE, OR COMMERCIAL LOSS OR FROM ANY OTHER LOSS OR DAMAGE EXCEPT AS SET FORTH HEREIN. The Schebler Company assumes no liability for any damages resulting in whole or part from misuse, improper installation, or inadequate maintenance of the system or component part thereof, nor assumes or authorizes any other person or entity to assume on its behalf any other liability in connection with the sale of its products.

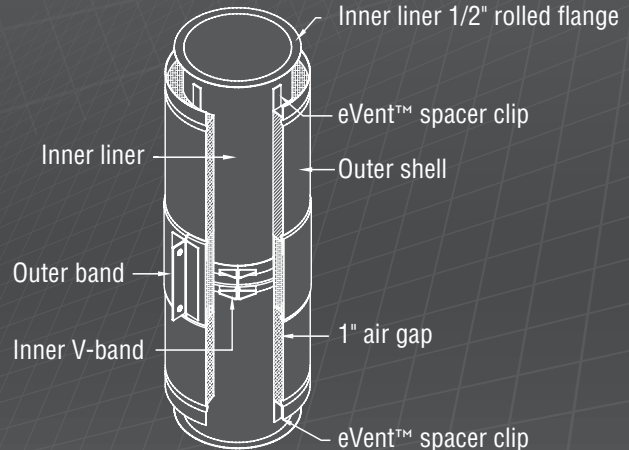

P 800.391.0009 • 563.359.0110
5665 FENNO RD
BETTENDORF, IOWA 52722
WWW.SCHEBLERCHIMNEY.COM