

The door seal in the valve assembly for the 2" and 3" size compound series meters is replaceable, should it become necessary, with the use of the Door Seal Replacement Tool Kit (64201-001.) This instruction sheet provides step by step instructions for use of this kit. The 4" and 6" size valve assemblies do not permit door seal replacement and if service/replacement is required, a new complete valve assembly must be installed.

DOOR SEAL REPLACEMENT PROCEDURE

Remove the bolts on the cover assembly and lift the assembly from the housing. (See Figure 1.)

After removal of Cover Assembly, the Valve Assembly is now exposed for service. Remove lock pawl (Figure 1). Now, turn the Valve Assembly counter-clockwise to unthread from housing. When complete, simply lift out of housing.

Remove bolt, nut and washers pointed out in Figures 2 and 3.

The kit is made up of a spacer and bolt (2 sizes of bolts - one with washer for 2", a larger bolt/no washer for 3".- See Figure 4.)

Assemble spacer with bolt to threaded hole on back of valve assembly. (See Figures 5, 6 and 7.)

With wrench, turn bolt head clockwise to open door, and expose door seal for removal (about 1/2" opening - See Figure 8.)

Remove seal and replace with new seal. Turn bolt counter-clockwise until door has closed. (See Figure 9.)

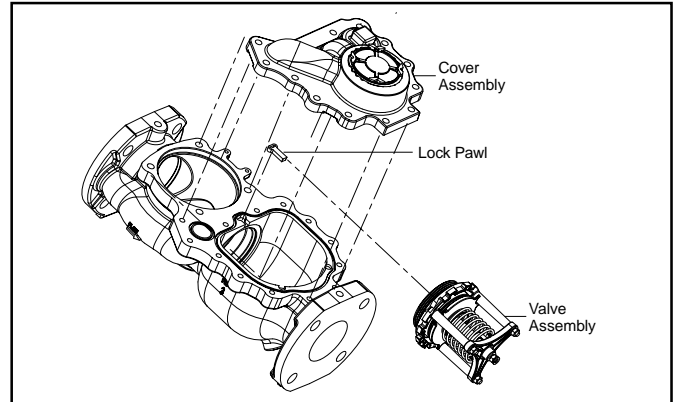

Figure 1

Replace bolt, nut and washers removed as shown in Figure 2. Reinstall valve assembly in meter housing. Place lock pawl in position.

Position cover assembly back in place and reassemble bolts. Badger recommends that a new "O"-ring be used after each teardown and reassembly of the Cover Assembly. To assure a tight seal, make sure "O"-ring is positioned correctly on housing and Cover Assembly are clean and free of dirt or residual traces of old "O"-ring material. If necessary, use silicone grease to help retain "O" ring and to serve as a lubricant in reassembly to housing.

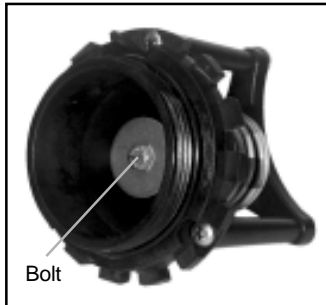

Figure 2

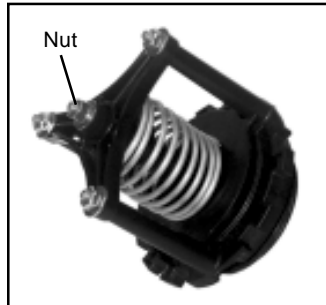

Figure 3

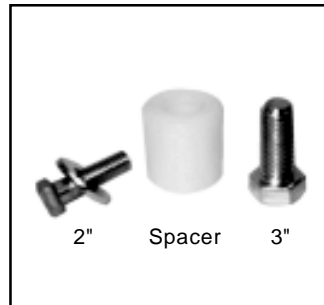

Figure 4

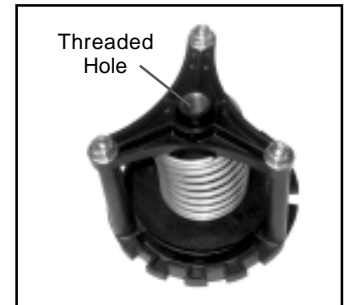

Figure 5



Figure 6



Figure 7



Figure 8



Figure 9

Recordall® is a registered trademark of Badger Meter, Inc.

RCS-I-1
P/N 62935-005
12-01



Please see our website at
www.badgermeter.com
for specific contacts.

Due to continuous research, product improvements and enhancements, Badger Meter reserves the right to change product or system specifications without notice, except to the extent an outstanding bid obligation exists.



BadgerMeter, Inc.

P.O. Box 245036, Milwaukee, WI 53224-9536
(800) 876-3837 / Fax: (888) 371-5982

www.badgermeter.com